

# SCRANTON

3015-AGB

Inspired by the shape of an apple, Scranton features a softly defined outer layer of etched glass and a narrow 'core' of shiny opal glass within. The freshness of the organic silhouette, paired with the sleek glass layers and metal accents, makes it perfect for a dining room or kitchen. Scranton is available in two sizes and two finishes, Aged Brass and Old Bronze.

## FINISHES

AGED BRASS

## DIMENSIONS / SPECS

Height: 66"  
Width/Diameter: 66"  
Length: 66"  
Minimum Height: 66"  
Maximum Height: 66"  
Canopy/Backplate: 6"  
Hanging Type: 108" Premium Composite Cord  
Product Weight: 66lb  
Extension: 66"  
Top to Center: 66"  
Canopy/Backplate Shape: Round  
Sloped Ceiling Compatible: No  
Living Finish: Yes  
Uplight Only: Yes  
Min Extension: 66"  
Max Extension: 66"

Shade 1: Glass  
Shade 1 Finish: Clear Etched  
Shade 1 Top Width: 15"  
Shade 1 Height: 13.25"  
Shade 2: Glass  
Shade 2 Finish: Opal Glossy  
Shade 2 Top Width: 3.75"  
Shade 2 Height: 12"

## ELECTRICAL



### Bulb 1

Bulb Included: N/A  
Socket: Integrated LED  
Max Wattage: 20  
Bulb Quantity: 1  
Wire Length: 500mm  
Cord Type: ! New Cord Type  
Dimmer Type: Incandescent  
Switch Type: ON/OFF STOMP SWITCH  
Gem Box Required (2"x3"): Yes  
Dark Sky: Yes  
CRI: 66  
Color Temp.: 66k  
Lumens: 66  
Title 24: Yes  
Field Serviceable: No

### Battery

Battery Powered: Yes  
Battery Included: Yes  
Battery Life: ! New Battery Life !

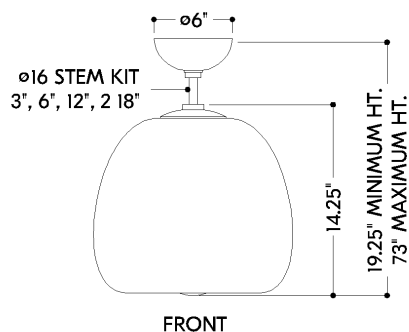

FRONT

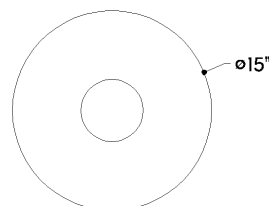

BOTTOM

# SCRANTON

3015-AGB

---

## SHIPPING

---

Carton 1: 24" x 24" x 28"

Carton 1 Weight: 19lb

Shipping Method: Ground

Country of Origin: CN