

VANCOUVER

4220-AGB

Embodying understated elegance, this versatile sconce features a hurricane lamp made from clear glass supported by an Aged Brass or Old Bronze frame. Within the shade is an energy-efficient LED encased in an opal glossy glass tube, diffusing light evenly throughout small spaces.

FINISHES



AGED BRASS

Coastal Suitable Finish (EPM): Yes

DIMENSIONS

Height: 66"
Width/Diameter: 66"
Length: 66"
Minimum Height: 66"
Maximum Height: 66"
Canopy/Backplate: 4.75"
Hanging Type: 108" Premium Composite Cord
Product Weight: 66lb
Extension: 66"
Top to Center: 66"
Canopy/Backplate Shape: Round
Sloped Ceiling Compatible: No
Living Finish: Yes
Uplight Only: Yes

Shade

Shade 1: Acrylic
Shade 1 Finish: Clear
Shade 1 Top Width: 2"
Shade 1 Height: 12.75"
Shade 2: Glass
Shade 2 Finish: Opal Shiny
Shade 2 Top Width: 4.25"
Shade 2 Bottom L/W: 0" / 2.75"
Shade 2 Height: 14.75"

ELECTRICAL



Bulb 1

Bulb Included: N/A
Socket: Integrated LED
Max Wattage: 8
Bulb Quantity: 1
Wire Length: 500mm
Cord Type: ! New Cord Type
Dimmer Type: Incandescent
Switch Type: ON/OFF STOMP SWITCH
Gem Box Required (2"x3"): Yes
Dark Sky: Yes
CRI: 66
Color Temp.: 66k
Lumens: 66
Title 24: Yes
Field Serviceable: No

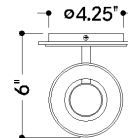

TOP

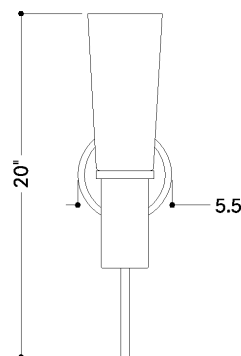

FRONT

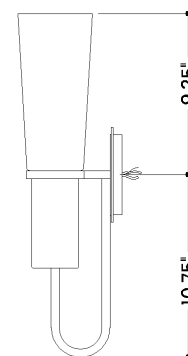

SIDE

VANCOUVER

4220-AGB

Battery

Battery Powered: Yes

Battery Included: Yes

Battery Life: ! New Battery Life !

SHIPPING

Carton 1: 24" x 16" x 9"

Carton 1 Weight: 7lb

Shipping Method: Ground

Country of Origin: VN