

MONA

H908101-AGB

Simple yet elevated, the totemic silhouette of Mona makes a playful first impression. Stacked between a large opal shiny glass shade and tapered Aged Brass cuff is a striking Calacatta gold marble sphere. When viewed from the front, the Aged Brass back panel encircles the marble like a halo, completing the puzzle-like composition. Part of our Megan Molten x Mitzi Tastemakers collection.

*Due to the one-of-a-kind nature of the medium, exact colors and patterns may vary slightly from the image shown.

FINISHES

AGED BRASS

Coastal Suitable Finish (EPM): No

DIMENSIONS

Height: 11.25"

Width/Diameter: 6"

Canopy/Backplate: 4.75"

Product Weight: 3.7lb

Extension: 6.75"

Top to Center: 8"

Canopy/Backplate Shape: Round

Sloped Ceiling Compatible: No

Living Finish: No

Uplight Only: No

Shade

Shade 1: Glass

Shade 1 Finish: Opal Shiny

Shade 1 Top Width: 6"

Shade 1 Bottom L/W: 0" / 2"

Shade 1 Height: 6.75"

ELECTRICAL



Bulb 1

Bulb Included: No

Socket: E12 Candelabra Base

Bulb Type: T8-3.5

Max Wattage: 8

Bulb Quantity: 1

Bulb Included: No

Cord Type: B & W TEFLON W/ GROUND WIRE

Gem Box Required (2"x3"): No

Dark Sky: No

SHIPPING

Carton 1: 17" x 10" x 7"

Carton 1 Weight: 6lb

Shipping Method: Ground

Country of Origin: VN

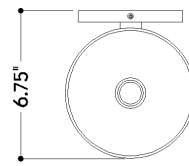

TOP

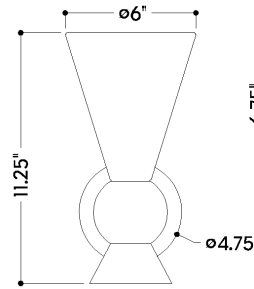

FRONT

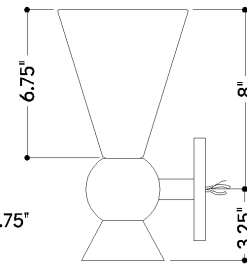

SIDE